

# High Pressure Misting Pump



## - PJ-A TYPE

### ■ Specification :

- Working Pressure : 70 bar/ 1000psi
- With water gauge, adjustable pressure regulator
- High pressure durable brass-casting making of pump head
- Precise Ceramic 3 Plungers (ceramic + stainless steel for 1HP up ), Japan top quality ceramic materials
- Japan-made Pump bearing or equal quality level
- Germany-made water seal and stainless steel pump valve
- Aluminum alloy motor housing

1/2HP, 1/3HP Pump break down

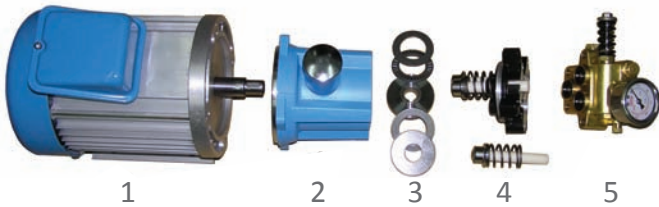

1HP Pump break down

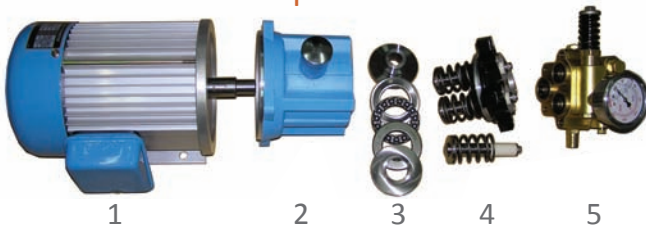

3HP Pump break down

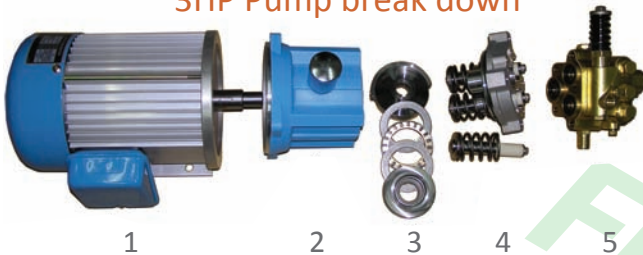

1. High efficient motor
2. Transmission box
3. Transmission assy
4. Fine lapping ceramics plunger
5. High-pressure copper forged plunger pump booster



PUMP SERIES

Model No.	Horse Power	Flow Rate LPM Approx.	Phase
PJ-A20307	1/3 HP	1.2L/50Hz 1.5L/60Hz	single
PJ-A20507	1/2 HP	2.4L/50Hz 3L/60Hz	single
PJ-A2107	1 HP	5L	Single / Three
PJ-A21507	1.5 HP	9L	Single / Three
PJ-A2207	2 HP	12L	Single / Three
PJ-A2307	3 HP	15L/50Hz 18L/60Hz	Three
PJ-A2507	5 HP	18L/50Hz 22L/60Hz	Three