



# Patio 5 Misting Kit



### Kit Includes

- 5 0.3mm mist nozzles
- 4 slip-lok nozzle holder
- 1 slip-lok elbow
- 1 slip-lok one nozzle end plug
- 2.5m misting line and 4m water supply line
- tap adaptor
- inline poly phosphate filter
- 15 saddles
- zip ties

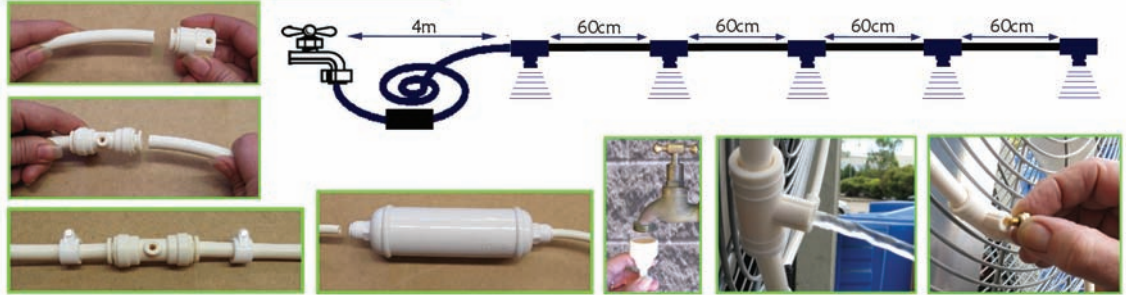

1. Roll out hose and slide end plug onto one end of the hose. Tip: Dip end of hose in water to make it easier to slide into fittings.
2. Cut hose 60cm from end plug and slide both ends of cut hose into nozzle holder. Repeat this process until all nozzle holders are used, keeping your spacing at 60cm between each nozzle holder.
3. Secure misting line in desired position using saddles.
4. Attach tap adaptor to hose and connect to faucet. Cut hose approximately 1m, from tap adaptor and slide hose into the poly phosphate filter. Turn on the tap to flush out your misting line.
5. Twist nozzles into the nozzle holders.

# Patio 10 Misting Kit



### Kit Includes

- 10 0.3mm mist nozzles
- 9 slip-lok nozzle holder
- 1 slip-lok elbow
- 1 slip-lok one nozzle end plug
- 5m misting line and 4m water supply line
- tap adaptor
- inline poly phosphate filter
- 30 saddles
- zip ties

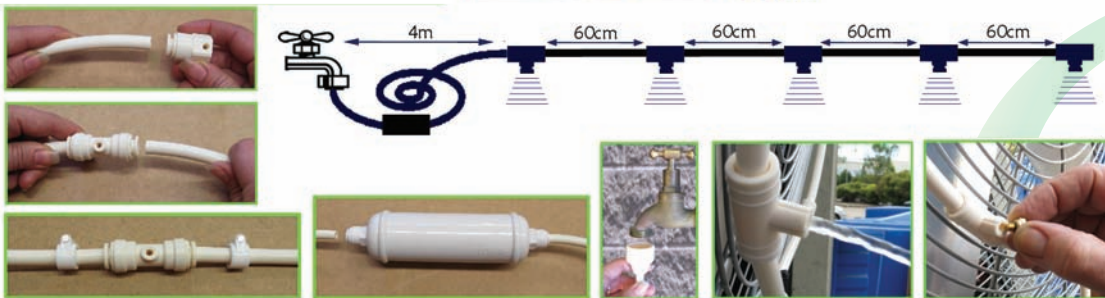

1. Roll out hose and slide end plug onto one end of the hose. Tip: Dip end of hose in water to make it easier to slide into fittings.
2. Cut hose 60cm from end plug and slide both ends of cut hose into nozzle holder. Repeat this process until all nozzle holders are used, keeping your spacing at 60cm between each nozzle holder.
3. Secure misting line in desired position using saddles.
4. Attach tap adaptor to hose and connect to faucet. Cut hose approximately 1m, from tap adaptor and slide hose into the poly phosphate filter. Turn on the tap to flush out your misting line.
5. Twist nozzles into the nozzle holders.

